



SPECIFICATION SHEET

TAPE-30-RGB

DESCRIPTION

- Fully dimmable and color controllable
- Double sided 3m tape backing
- Low power consumption
- Low heat emission
- Available in IP20 or IP68
- Easy to install



Dimmable Lighting
0 to 100% flicker free dimming



RGB



Working Temperature
-10°C to +40°C



3 Year Limited Warranty



SPECIFICATIONS

LED Quantity:	30 LED/M
Color /CCT:	RGB
Chip:	EPISTAR
CRI:	N/A
Bin/Step:	1 bin only, 4 step binning
Luminous Flux per meter/3.3FT:	600Lm/M
Beam Angle:	120°
Power Rating per meter/3.3FT:	8.16W, 24V, 0.34A
PCB Width:	10mm (IP68 - 12.5mm)
Cut Length:	166mm/6.5" or 5 LEDs
IP Rating:	IP20/IP68
Max Run Length:	5 meters (16.4FT/Roll)
Lifespan:	50,000 hrs
Warranty:	3 years
Certificate:	CE, RoHS, UL Listed
Compatible Drivers:	Use SRPC 2108-24V-200, SR-2108A-M5, or SR-2108B-M24 driver/decoder
Packaging:	16.4 FT spool IP20= 100g/roll - IP68= 300g/roll

MODEL CODES	DESCRIPTION
TAPE-30-RGB	Tape 30 LED/M, RGB, 8.16W/M, 95+, 600Lm/M, 5M (16.4FT/Roll), 10mm, 24V, IP20
TAPE-30-RGB-IP68	Tape 30 LED/M, RGB, 8.16W/M, 95+, 600Lm/M, 5M (16.4FT/Roll), 12.5mm, Dimmable, 24V, IP68



TAPE-30-RGB



TAPE-30-RGB-IP68

COLOR TEMPERATURE

RGB



TYPICAL APPLICATIONS

- ✓ Accent lighting
- ✓ Decorative lighting
- ✓ Architectural lighting

CUT LENGTH

166mm/6.5" or 5 LEDs

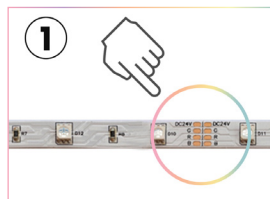

Find the cut line on the strip (between the solder pads).

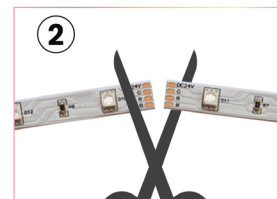

Carefully cut the strip on the cut line.

COMPATIBLE TRACKS

*For a dot-less result use one of these recommended track diffuser combinations.

**Tapes with IP68 fit in tracks with an inner width of 12.5mm or more.

TRACK-OP-002

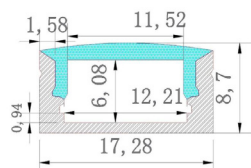

TRACK-OP-004

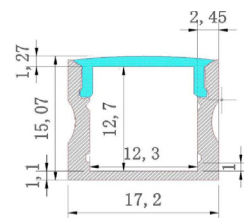

TRACK-OP-006

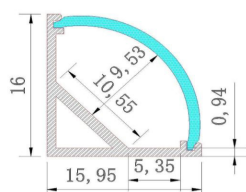

TRACK-OP-008

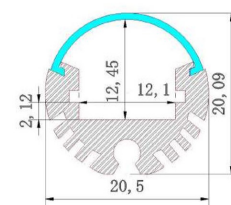

TRACK-OP-010

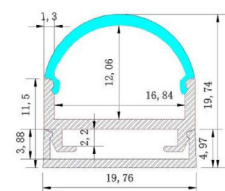

TRACK-OP-011

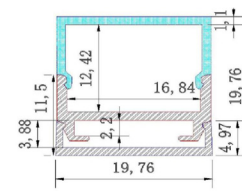

TRACK-OP-013

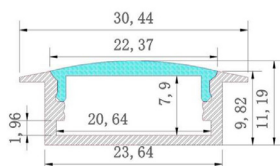

TRACK-OP-014

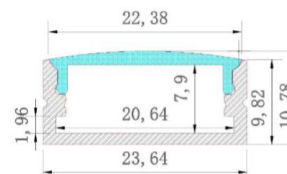

TRACK-OP-035

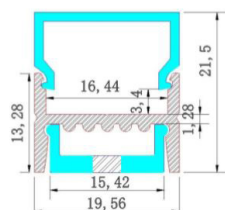

TRACK-OP-036

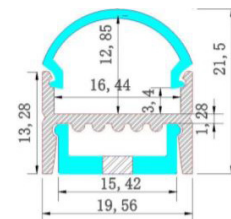
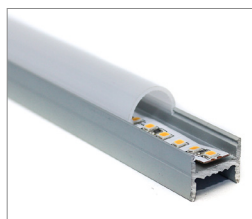

COMPATIBLE TRIMLESS TRACKS

**For a dot-less result use one of these recommended trimless track diffuser combinations.*

TRACK-OP-039-TL

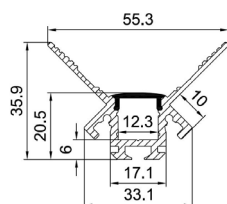

TRACK-OP-040-TL

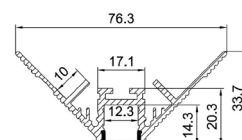

TRACK-OP-055-TL

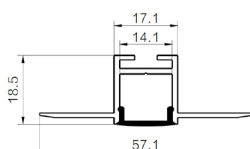

TRACK-OP-056-TL

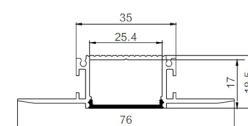

TRACK-OP-079-TL

