



## SPECIFICATION SHEET

# TAPE-60-RGB

### DESCRIPTION

- Fully dimmable and color controllable
- Double sided 3m tape backing
- Low power consumption
- Low heat emission
- Available in IP20 or IP68
- Easy to install



Dimmable Lighting  
0 to 100% flicker free dimming



RGB



Working Temperature



3 Year Limited  
Warranty



### SPECIFICATIONS

LED Quantity:	60 LED/M
Color /CCT:	RGB
Chip:	EPISTAR
CRI:	N/A
Bin/Step:	1 bin only, 4 step binning
Luminous Flux per meter/3.3FT:	1200Lm/M
Beam Angle:	120°
Power Rating per meter/3.3FT:	14.4W, 24V, 0.6A
PCB Width:	10mm (IP68 - 12.4mm)
Cut Length:	100mm/4" or 6 LEDs
IP Rating:	IP20/IP68
Max Run Length:	5 meters (16.4FT/Roll)
Lifespan:	50,000 hrs
Warranty:	3 years
Certificate:	CE, RoHS, UL Listed
Compatible Drivers:	Use SRPC 2108-24V-200, SR-2108A-M5, or SR-2108B-M24 driver/decoder
Packaging:	16.4 FT spool IP20= 120g/roll - IP68= 320g/roll

MODEL CODES	DESCRIPTION
TAPE-60-RGB	Tape 60 LED/M, RGB, 14.4W/M, 95+, 1200Lm/M, 5M (16.4FT/Roll), 10mm, Dimmable, 24V, IP20
TAPE-60-RGB-IP68	Tape 60 LED/M, RGB, 14.4W/M, 95+, 1200Lm/M, 5M (16.4FT/Roll), 12.4mm, Dimmable, 24V, IP68



TAPE-60-RGB



TAPE-60-RGB-IP68

### COLOR TEMPERATURE

RGB



### TYPICAL APPLICATIONS

- ✓ Accent lighting
- ✓ Decorative lighting
- ✓ Architectural lighting

### CUT LENGTH

100mm/4" or 6 LEDs

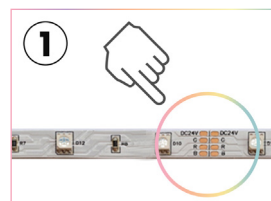

Find the cut line on the strip  
(between the solder pads).



Carefully cut the strip on the  
cut line.

### COMPATIBLE TRACKS

\*For a dot-less result use one of these recommended track diffuser combinations.

\*\*Tapes with IP68 fit in tracks with an inner width of 12.4mm or more.

**TRACK-OP-002**

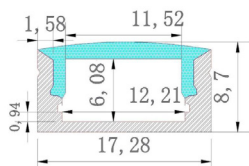

**TRACK-OP-004**

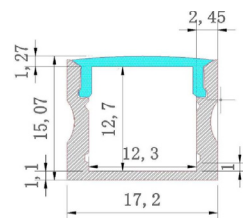

**TRACK-OP-006**

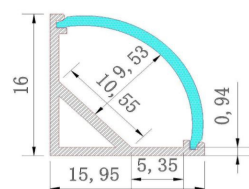

**TRACK-OP-008**

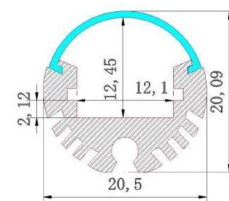

**TRACK-OP-010**

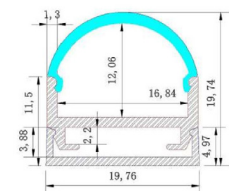

**TRACK-OP-011**

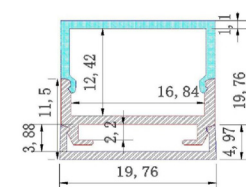

**TRACK-OP-013**

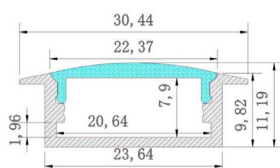

**TRACK-OP-014**

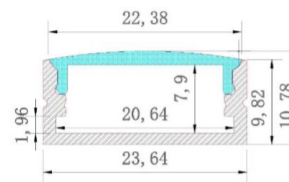

**TRACK-OP-035**

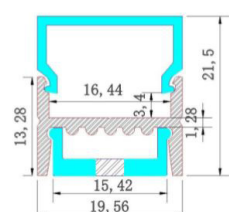

**TRACK-OP-036**

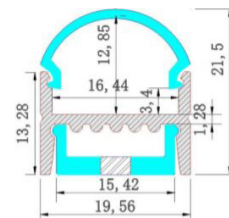

### COMPATIBLE TRIMLESS TRACKS

*\*For a dot-less result use one of these recommended trimless track diffuser combinations.*

**TRACK-OP-039-TL**

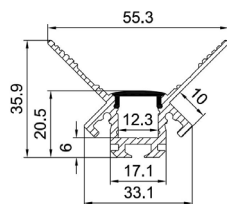

**TRACK-OP-040-TL**

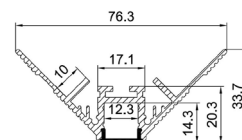

**TRACK-OP-055-TL**

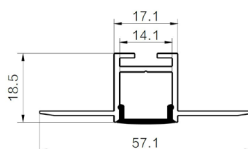

**TRACK-OP-056-TL**

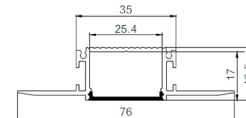

**TRACK-OP-079-TL**

