

FLOOD LIGHT SERIES – WHITE

FL Series offers high lumen output while reducing energy consumption. Our selection of flood lights are ideal for landscape lighting, small driveways as well as other indoor and outdoor applications.



DESCRIPTION

- Built with high powered 219 LED
- A light, compact and heat dissipating aluminum extrusion design.
- High Quality waterproof design and construction.
- Condensation valve regulates internal housing temperature.
- Modular LED board design offers quick and easy maintenance
- Top cover manufactured with superior plastics preventing yellowing and brittleness over time.

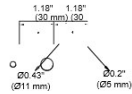
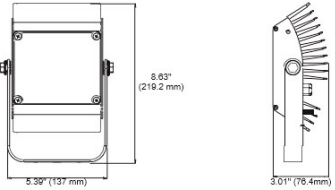
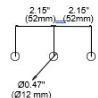
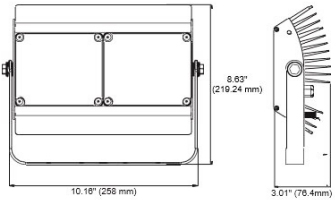
Model	Installation	Dimensions
FL1 50W		 <p>Weight 1300 g</p>
FL2 100W		 <p>Weight 2500 g</p>

FL1 SERIES

MODEL CODES	DESCRIPTION
FL1-W27K-25D	Floodlight 24V, 50W, White 2700K, 25D, IP67
FL1-W27K-40D	Floodlight 24V, 50W, White 2700K, 40D, IP67
FL1-W27K-60D	Floodlight 24V, 50W, White 2700K, 60D, IP67



FL2 SERIES

MODEL CODES	DESCRIPTION
FL2-W27K-25D	Floodlight 24V, 100W, White 2700K, 25D, IP67
FL2-W27K-40D	Floodlight 24V, 100W, White 2700K, 40D, IP67
FL2-W27K-60D	Floodlight 24V, 100W, White 2700K, 60D, IP67





SPECIFICATION SHEET

FL1/FL2 SERIES WHITE

FEATURES

SPECIFICATIONS										
MODEL	Power Consumption	Power Requirement	Color Temp	Luminous Flux (Lm)	CRI	Efficiency (Lm/W)	LEDS	Dimmer	IP Rating	Beam Angle
FL1	50W	24VDC 2.1A	Warm White (2700K)	4200	80	84 Lm	NICHIA 219 x 18 LEDs	Yes	IP67	25° 40° 60°
FL2	100W	24VDC 2.1A	Warm White (2700K)	8400	80	84 Lm	NICHIA 219 x 36 LEDs			

Fixture Warranty: 3 Years

*Installation and usage of this product outside of normal operation conditions and installation guide lines void warranty.

DECODER

Compatible Decoder	SR-2108A-M5-5, GATEway 1DMX
Power Supply	HLG-320H-24-A
DMX Cable Connector	22AWG x 2C, Cable end with bare wire
Exit Cable Length	2M

ENVIRONMENT

Temperature	-10°C ~ 40°C
-------------	--------------

HOUSING

Color	Black
Lens	Optical Grade PMMA
Material	Premium Grade Aluminum, Weatherproof PC (UV-resistant)
Accessories	Hanging bracket

Remark:

Based on LED manufacturers testing, MTBF (mean time between failure) under normal operating conditions is set at 100,000 hours. Normal operating conditions include but are not limited to: ambient temperature range of -4 to 104 degrees F (-20 to 40 degrees C) humidity range of 0-95% non-condensing, adequate ventilation and air flow.

DIMENSIONS

FL1 50W

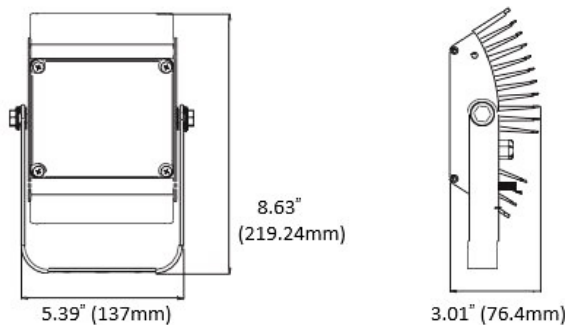

Weight: 1300 g

FL2 100W

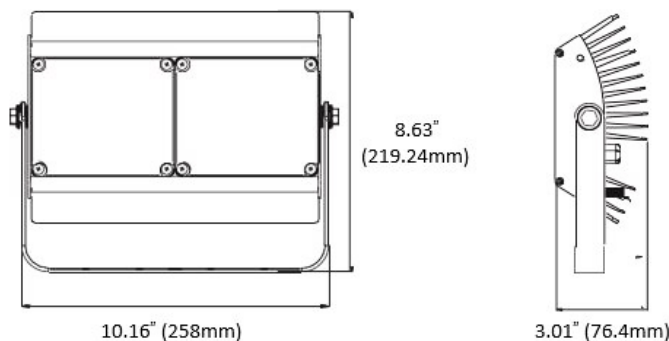

Weight: 2500 g

INSTALLATION

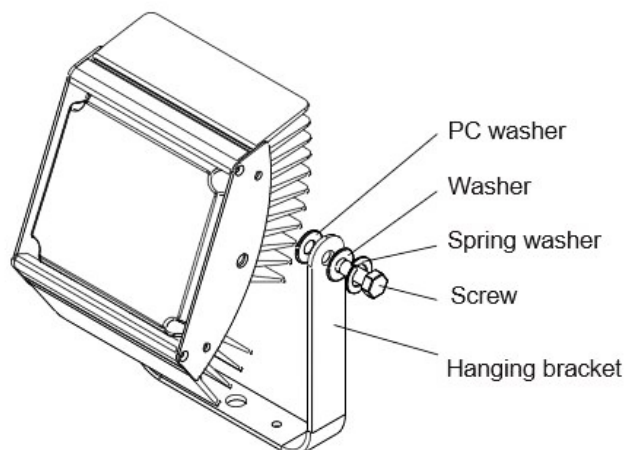



SPECIFICATION SHEET FL1/FL2 SERIES WHITE

WIRING CONFIGURATION

OPERATING SAFEGUARDS

1. These are powerful light fixtures. Do not look directly at the light for any extended period of time. Do not shine the light in other people's direction.
2. Contact an authorized Colorbeam Lighting dealer for warranty and maintenance issues.
3. Do not cover the light fixture with other objects
4. Do not expose light fixtures to open flames or external heat sources
5. Use under normal heat and humidity operating ranges as indicated in section "Specifications"

INSTALLATION WARNINGS

1. Do not install any lights that appear to have been damaged during shipping.
2. This product should be installed by a qualified Colorbeam Lighting certified dealer.
3. Do not install the light fixture less than 20cm away from any flammable material.
4. Install lights in a well ventilated area. Do not install light fixture surrounded by any insulation materials.
5. Use only specified Colorbeam Lighting drivers to power the light fixtures.



SRPC-2108-24-200CVF Driver Setting for Single White luminaires: CH 04
DP 1.1

Use speaker cables with 2 conductors
Connect in Parallel: Power wires on pin +
Single White wires on 1-, 2-, and 3-
No more than three FL-1 Single White for a SRPC-2108-24-200CVF
200W internal power supply (80% power consumption recommended)

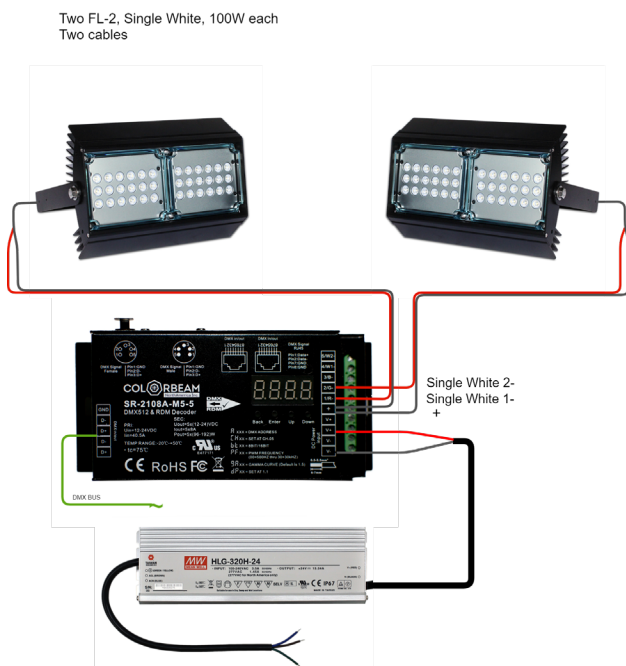

SR-2108A-M5-5 Decoder Setting for Single White luminaires: CH 05
DP 1.1

Use speaker cables with 2 conductors
Connect in Parallel: Power wire on pin +
Single colour wires on 1- and 2-
No more than two FL-2 Single White for a 320W Mean-Well power supply

www.colorbeamlighting.com