

TOUCH PANEL DMX MASTER CONTROLLER

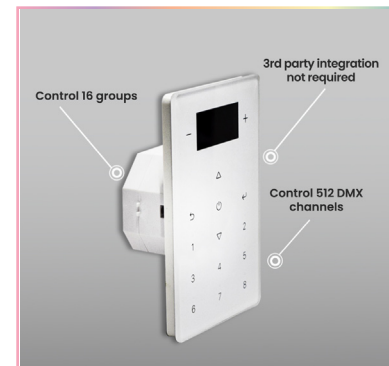

TOUCH PANEL 5 IN 1

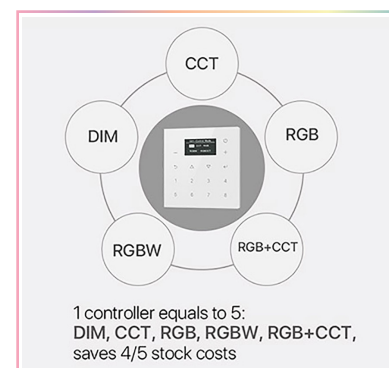

DESCRIPTION

- The DMX-KP-512 control panel is a master controller designed to control the DMX decoders.
- It can control 512 DMX channels.
- It enables to configure max. 16 groups or zones with max. 8 scenes, 24 time schedules and 8 cycle schedules configured to each group.
- The panel supports 5 different types of DMX load: Dim, CCT, RGB, RGBW, RGB+CCT.
- 3 years warranty

ELECTRIC PARAMETERS

Output Signal	DMX512 signal
Power Supply	100-240VAC, 50/60Hz
Power Consumption	< 15 mA
Operating Temperature	0-40°C
Relative humidity	8% to 80%
Dimensions	75x120x41mm

"The DMX-KP-512 keypad should be installed in approved electrical box."

DIMENSIONS

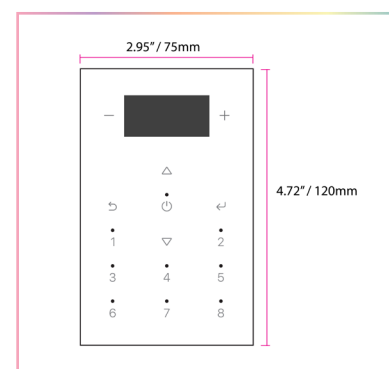

OPERATIONS

KEY FUNCTION DEFINITION & DESCRIPTION

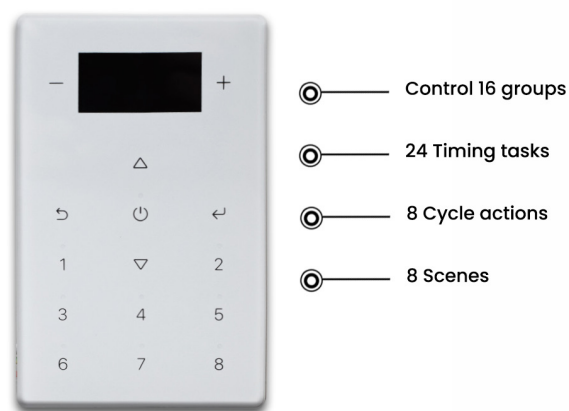
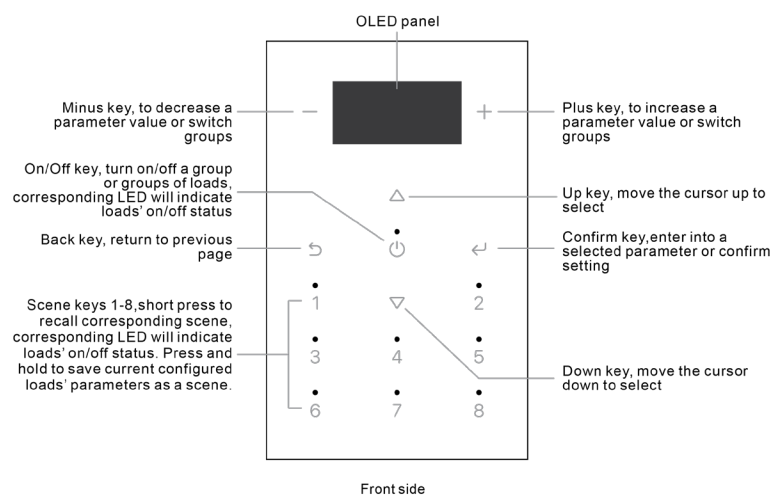

WIRING DIAGRAM

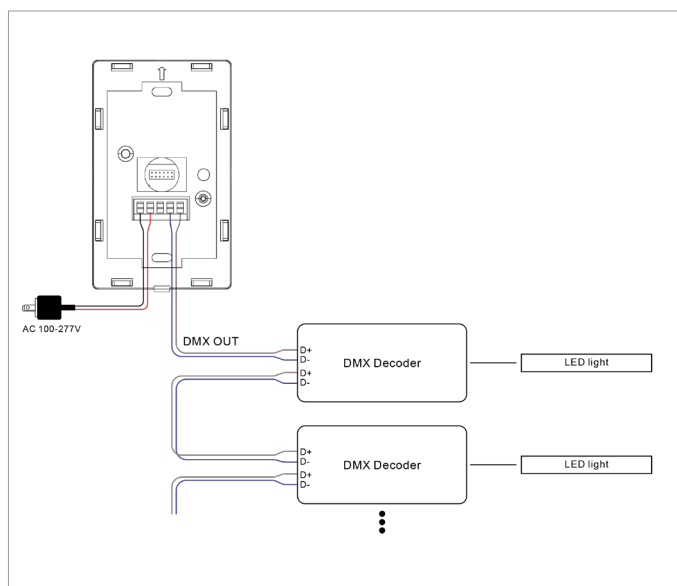

OVERALL DIMENSIONS

