



SPECIFICATION SHEET

TAPE-120-W

DESCRIPTION

- Fully dimmable
- Double sided 3m tape backing
- Low power consumption
- Low heat emission
- Available in IP20
- Easy to install

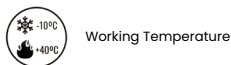
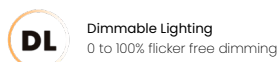

SPECIFICATIONS

LED Quantity:	120 LED/M
Color /CCT:	3000K
Chip:	EPISTAR
CRI:	Ra+95
Bin/Step:	1 bin only, 4 step binning
Luminous Flux per meter/3.3FT:	1300 Lm
Beam Angle:	120°
Power Rating per meter/3.3FT:	14.4W, 24V, 0.4A
PCB Width:	10mm
Cut Length:	50mm/2" or 6 LEDs
IP Rating:	IP20
Max Run Length:	5 meters (16.4FT/Roll)
Lifespan:	50,000 hrs
Warranty:	7 years
Certificate:	CE, RoHS, UL Listed
Compatible Drivers:	Use SRPC 2108-24V-200, SR-2108A-M5, or SR-2108B-M24 driver/decoder
Packaging:	16.4 FT spool IP20= 105g/roll

MODEL CODES	DESCRIPTION
TAPE-120-W30K	Tape 120 LED/M, 3000K, 14.4W/M, 95+, 1300Lm/M, 5M (16.4FT/Roll), 10mm, Dimmable, 24V, IP20



COLOR TEMPERATURE



TYPICAL APPLICATIONS

- ✓ Accent lighting
- ✓ Decorative lighting
- ✓ Architectural lighting

CUT LENGTH

50mm/2" or 6 LEDs

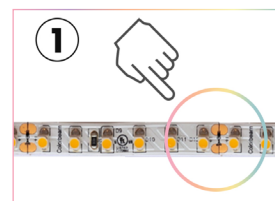

Find the cut line on the strip (between the solder pads).



Carefully cut the strip on the cut line.

COMPATIBLE TRACKS

**For a dot-less result, use one of these recommended track diffuser combinations.*

TRACK-OP-002

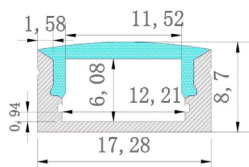

TRACK-OP-004

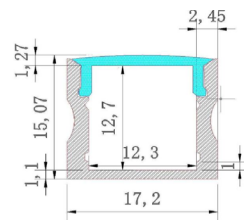

TRACK-OP-006

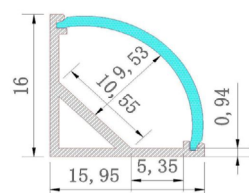

TRACK-OP-008

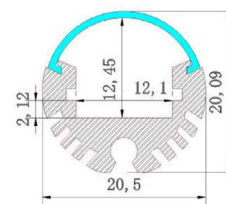

TRACK-OP-010

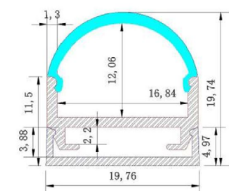

TRACK-OP-011

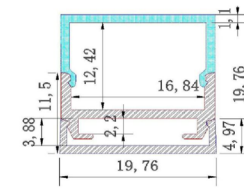

TRACK-OP-013

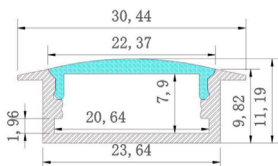

TRACK-OP-014

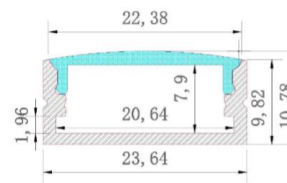

TRACK-OP-035

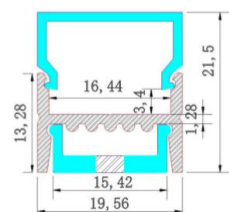

TRACK-OP-036

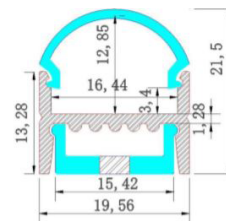

COMPATIBLE TRIMLESS TRACKS

**For a dot-less result use one of these recommended trimless track diffuser combinations.*

TRACK-OP-039-TL

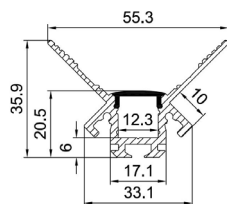

TRACK-OP-040-TL

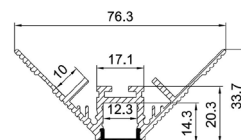

TRACK-OP-055-TL

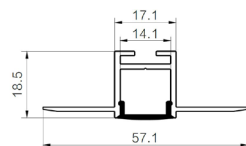

TRACK-OP-056-TL

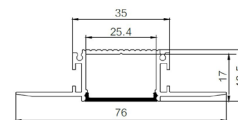

TRACK-OP-079-TL

